

Falcon-VV Duplex Net Weigh Bagger Scale

JEM has been manufacturing durable bagging scales for over 35 years. For handling free flowing products into open mouthed bags their product line includes:

Mechanical Scales

Digital Gross Weigh Scales - Product weighed in the bag

Digital Net Weigh Scales - Pre-weighed Product that is discharged into a bag

A COMPLETE WEIGHING SYSTEM FOR 20 BAG PER MINUTE. ALSO A FLEXIBLE BAGGING SYSTEM FOR BAGS WEIGHING 1 TO 10 LBS.

STANDARD FEATURES:

- Flexible bagging System for 1 to 10 lb. bag weights
- Complete weighing system for 20 bags per minute
- Multi dump feature available to accommodate larger bag weights
- Adjustable feeder speeds to obtain maximum accuracies or higher production rates
- Net weigh filling, specifically for pails, jugs, buckets, etc.
- Dual head scale system allows for one system usage if necessary
- Easy to clean between production runs
- USB data collection port with TCP-IP live data capabilities
- Multiple language options including English, Spanish and French
- IP69K Wash-down rating on stainless controller HMI
- Inclusion feeders and hoppers available for multi-micro applications. Duplex or double scale is standard but single, triple and quad systems are also available
- Three (3) cubic foot capacity
- Two (2), one (1) cubic foot capacity weigh hoppers with Rice Lake load cells and summing box package
- Two (2) Electro-magnetic 7" x 14" bulk vibratory pan feeders
- Two (2) Electro-magnetic 4" x 22" dribble vibratory pan feeders
- Four (4) 0-10 DC variable speed controllers with scale communication cards

**WATCH THE
FALCON IN USE**



- One (1) IT8000PM NTEP approved digital programmable scale controller with 100 recipe code storage
- One (1) Lakeview data kit for internal reporting and product traceability
- One (1) ounce or 28 gram accuracies at two (2) sigma on consistent free flowing products
- Fully radiused lower product transition and bag spout
- Electrical and pneumatic package (110/220V-1-60 at 10 amps and 2 CFM at 50 PSI. 50Hz is optional and an extra charge

OPTIONAL :

- Stainless steel contact surfaces, all stainless steel construction or all stainless Food Grade construction
- Dust tight enclosure with dust collection port
- Surge Hoppers and operator maintenance mezzanines
- Ingredient adder system for micro inclusion capabilities (up to two (2) additional products)
- Bag closing conveyors, sealers and sewing pedestals
- Auto-baggers or vertical form, fill and seal machines

Falcon-VV Duplex Net Weigh Bagger Scale *cont'd*

SIMPLEX MODEL DRAWINGS & DIMENSIONS:

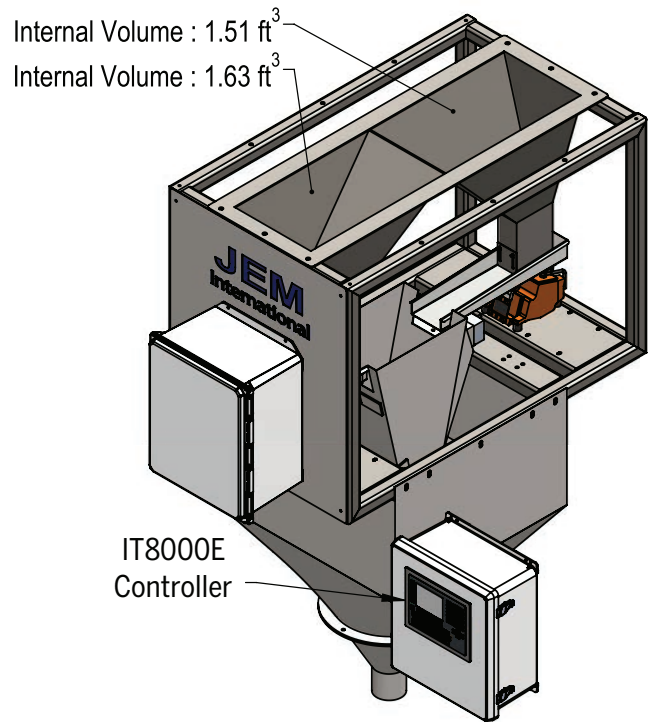
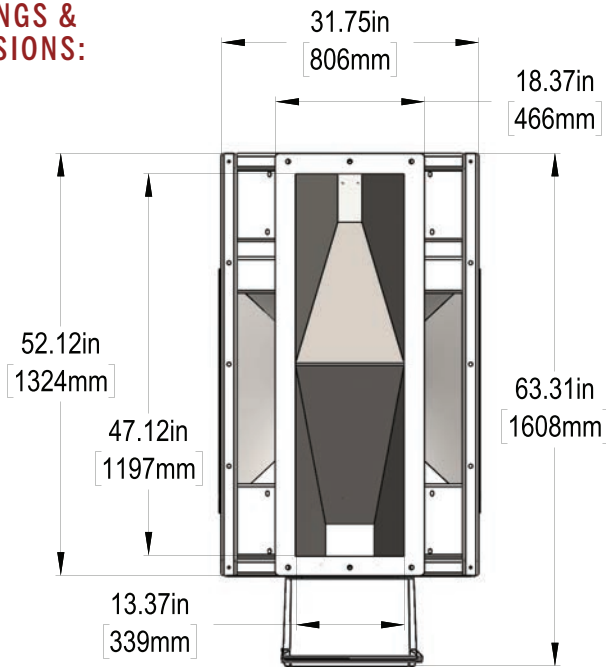

DIMENSIONS:

64" Length (160cm) x 32" Wide (80cm) x 80" Height (200cm) Add 20% for shipping dimensions

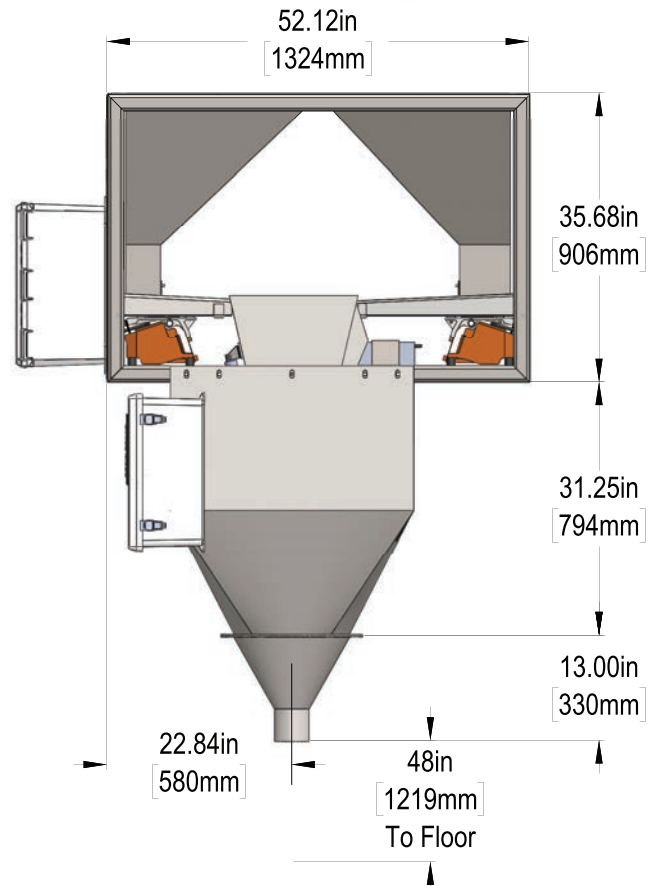
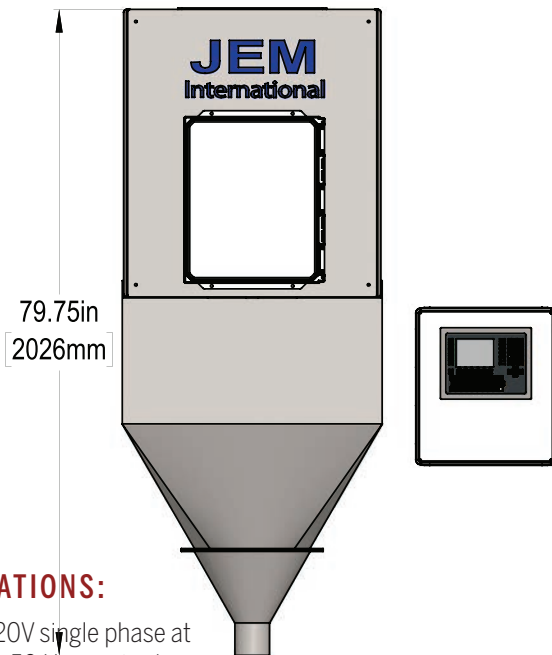

OTHER SPECIFICATIONS:

- Electrical 110V or 220V single phase at 60 Hertz (220V-1PH-50 Hz required and an extra charge)
- 110V/220VAC - 1Ph - 50/60 Hz - 6A
- 4-6 cfm at 80 psi

DUPLEX MODEL DRAWINGS & DIMENSIONS:

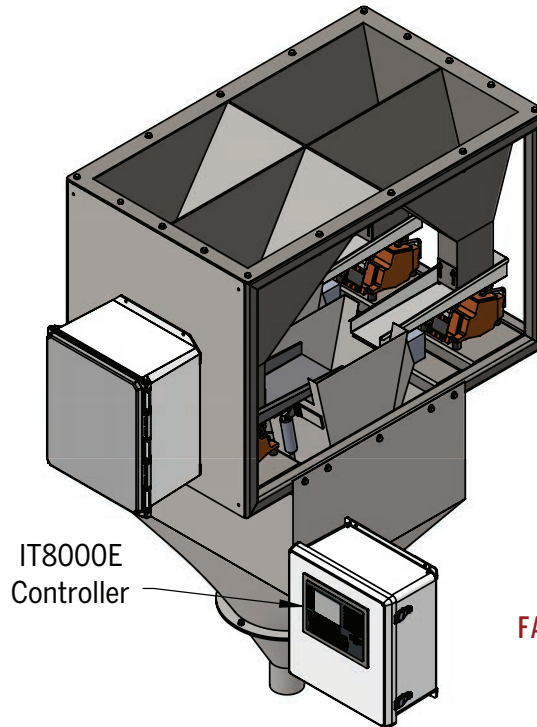
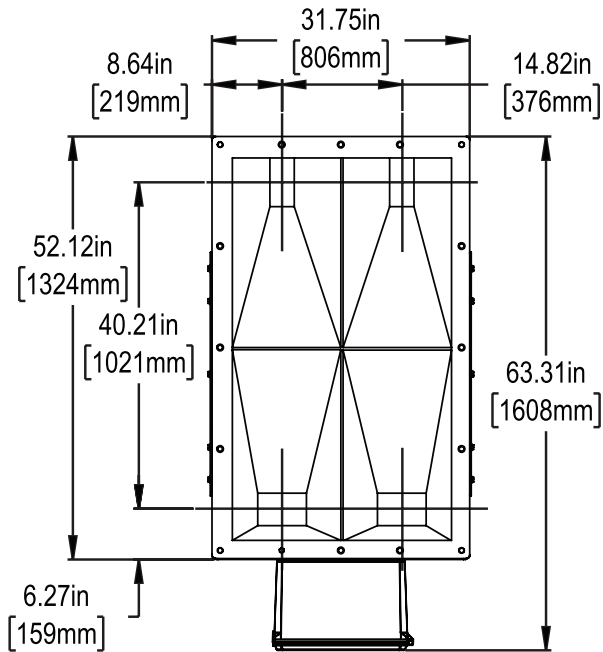

**WATCH THE
FALCON WEIGH BAG
SCALE IN USE**

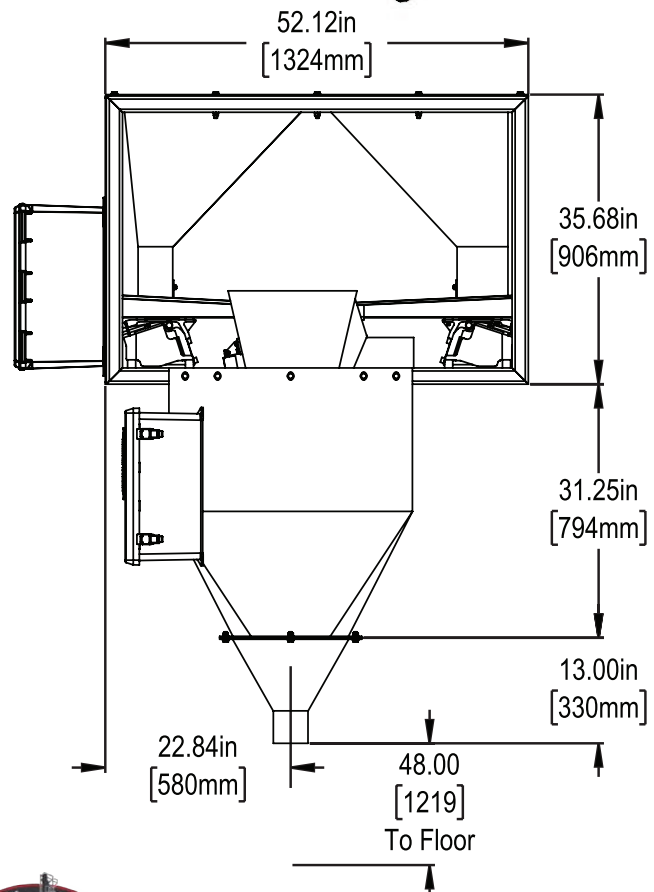
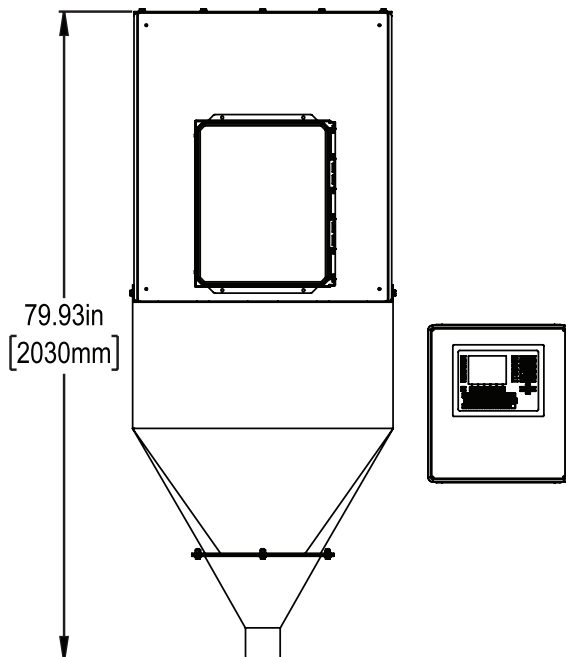

Supply Requirement

- Electrical: 110V/220VAC - 1Ph - 50/60 Hz - 6FLA
- Compressed Air: 80 psi at 4-6 cfm (3/8 in O.D. Min)

IT8000E - W & M Approved Weighing Terminal

STAINLESS STEEL HOUSING IP69K

Suitable for harsh environment weighing locations. With mounting brackets for desk-top or wall-mount installation. Integrated power supply unit, sealed cable glands for all cable connections.

SIMPLE AND FAST OPERATION

With integrated alphanumeric keyboard, function keys and programmable soft keys, optional full-size PC keyboard (cable or Bluetooth).

BRIGHT TFT COLOR DISPLAY

With wide viewing angle, large weight display and 4 to 8 input lines.

STATIONARY OR MOBILE USE

With integrated 110 - 240VAC power supply unit or via external 12/24VDC battery.

UNIVERSAL USE

The W&M approved IT8000E is designed for demanding industrial applications in the chemical and pharmaceutical industry, in the food industry and in many other sectors of industry. The industrial design with the powerful modular hardware and the concept of free programmability make the IT8000E the ideal weighing terminal for standard or application-specific solutions, eg for:

- Shipping and receiving
- Filling and batching systems
- Totalizing bulkweighers
- Checkweighers
- Vehicle / axle weighing
- Mobile data capture systems.

WEIGHING ELECTRONICS

1 or 2 internal and up to 6 external scale inter-faces possible. Adjustable update rate with up to 800 updates / second. High noise immunity of min. 10V/m against radio frequency interference. W&M approved resolution of up to 6000d with max. 80% preload. Calibration is possible as single or multiple-range (eg 3x3000d) and as multi-interval scale. Internal data archive for the storage of up to 120,000 weighing transactions.

MODULAR CONCEPT

The modular design provides for a variety of configurations and options, such as:

- Enclosures for wall-mount, desk-top or panel-mount installation or as blackbox
- DC or AC power supply
- Connection of scales with analog or digital force transducers
- 10/100 Mbps Ethernet interface with integrated web server, WLAN as option
- Integrated USB 2.0 host interface for printer, scanner and USB stick
- Up to 4 serial interfaces, RS232, RS485, RS422, 20mA CL selectable
- Flexible I/O concept for up to 64 inputs and outputs
- Fieldbus interfaces Ethernet/IP, Profibus DP, Profinet or Modbus TCP
- Analog I/Os, etc.

This ensures that the optimal system configuration can be chosen, for stationary as well as mobile use.

FREE PROGRAMMABILITY

Standard programs can be adapted to the requirements of specific



**FOR CHALLENGING WEIGHING
AND FILLING APPLICATIONS**
**FREELY PROGRAMMABLE INDUSTRIAL
WEIGHING TERMINAL**

applications. New programs can be designed and tested in a very simple way on a PC with the RTC program development environment.

SIMPLE INTEGRATION

The Linux based operating system with the integrated web server provides the ideal functionality for the integration of the IT8000E into local area networks.

WLAN communication and remote access via internet are also possible.



**WATCH THE
RECIPES & FEATURES
CONNECTIVITY VIDEO**



**WATCH THE
DIGITAL CONTROLLER
VIDEO**



**WATCH THE
DUPLEX CONTROLLER
VIDEO**

DATA COLLECTION SAMPLES:

EAGLE NET WEIGH

SEQID	RECIPE	LOT	DATE	TIME	TARGET	GROSS	Bags per minute 12 % of Error .06* *Based on Data Shown
1	SALT 50	7415	12/4/2017	9:19:47	50.00lb	50.00lb	
2	SALT 50	7415	12/4/2017	9:19:52	50.00lb	50.05lb	
3	SALT 50	7415	12/4/2017	9:19:57	50.00lb	50.00lb	
4	SALT 50	7415	12/4/2017	9:19:52	50.00lb	50.00lb	
5	SALT 50	7415	12/4/2017	9:19:58	50.00lb	50.05lb	
6	SALT 50	7415	12/4/2017	9:20:05	50.00lb	50.10lb	
7	SALT 50	7415	12/4/2017	9:20:10	50.00lb	50.05lb	
8	SALT 50	7415	12/4/2017	9:20:15	50.00lb	50.00lb	
9	SALT 50	7415	12/4/2017	9:20:20	50.00lb	50.05lb	
10	SALT 50	7415	12/4/2017	9:20:25	50.00lb	50.00lb	

FALCON NET WEIGH

SEQID	RECIPE	LOT	DATE	TIME	TARGET	GROSS	Bags per minute 20 % of Error .10* *Based on Data Shown
1	PET FOOD	WM123	12/3/2017	15:35:03	4.00lb	4.00lb	
2	PET FOOD	WM123	12/3/2017	15:35:06	4.00lb	4.00lb	
3	PET FOOD	WM123	12/3/2017	15:35:09	4.00lb	4.00lb	
4	PET FOOD	WM123	12/3/2017	15:35:13	4.00lb	4.02lb	
5	PET FOOD	WM123	12/3/2017	15:35:16	4.00lb	4.00lb	
6	PET FOOD	WM123	12/3/2017	15:35:19	4.00lb	4.00lb	
7	PET FOOD	WM123	12/3/2017	15:35:22	4.00lb	4.00lb	
8	PET FOOD	WM123	12/3/2017	15:35:25	4.00lb	4.00lb	
9	PET FOOD	WM123	12/3/2017	15:35:28	4.00lb	4.00lb	
10	PET FOOD	WM123	12/3/2017	15:35:31	4.00lb	4.02lb	

ROYAL GROSS WEIGH

SEQID	RECIPE	LOT	DATE	TIME	TARGET	GROSS	Bags per minute 7.5 % of Error .04* *Based on Data Shown
1	CORN25KG	WM123	11/30/2017	10:22:26	25.00lb	25.00lb	
2	CORN25KG	WM123	11/30/2017	10:22:34	25.00lb	25.02lb	
3	CORN25KG	WM123	11/30/2017	10:22:42	25.00lb	25.00lb	
4	CORN25KG	WM123	11/30/2017	10:22:50	25.00lb	25.00lb	
5	CORN25KG	WM123	11/30/2017	10:22:57	25.00lb	25.05lb	
6	CORN25KG	WM123	11/30/2017	10:23:05	25.00lb	25.02b	
7	CORN25KG	WM123	11/30/2017	10:22:13	25.00lb	25.00lb	
8	CORN25KG	WM123	11/30/2017	10:22:21	25.00lb	25.00lb	
9	CORN25KG	WM123	11/30/2017	10:22:29	25.00lb	25.02lb	
10	CORN25KG	WM123	11/30/2017	10:22:37	25.00lb	25.00lb	