

The Vertical Dehuller is primarily used in cereal grain for dehulling the barley and other grains. The process involves abrasion of the outer husk layer and removed the grain beard during preparation of the kernel (hulled barley) for the production of grits. The vertical dehuller DOO can also be used for dehulling of other cereals and seeds (wheat, rye, pea).

### OPERATION

The product is fed through the dehuller through the inlet (1 - see diagram on page 2), equipped with a sight glass, and passes through into a fixed cylindrical sleeve, inside of which there is a rotating impeller causing the abrasion and removal of the outer layer of husks and grain beards.



The impeller consists of a vertical hollowed shaft supported in bearings. Abrasive discs and distance segments are mounted alternatively on the shaft grooves.

Capacity as well as dehulling degree depends on the settings of the outer plate (2 - see diagram on page 2).

An Aspiration fan is mounted on the lower part of the dehuller and separates the hulls (husks, dust) and grains. The degree and intensity of dehulling can be regulated by the time the grain is retained in the machine as well as the quantity of air contained in the working chamber.

### CAPACITIES:

	Measurement	DOO 1	DOO 2
Barley (1st and 2nd dehulling)*	t/h	0,4-0,6	0,8-1,2
Barley (3rd dehulling)*	t/h		1.2-1,8

\* capacities above refer to barley sorted on sleeve with mesh 2,2x25 mm.

	Measurement	DOO 1	DOO 2
Power	kw	1,1	2,2
Shaft Revolutions	rpm	2020	2020

### DIMENSIONS AND WEIGHT:

	Measurement	DOO 1	DOO 2
A	mm	1360	1360
B	mm	770	770
H	mm	1395	1720
K	mm	265	308
Net Weight	kg.	750	975

### FAN PARAMETERS:

	Measurement	DOO 1	DOO 2
Capacity	m <sup>3</sup> / min	15	15
Compression	pa	700	700

For optional yield of kernel (hulled barley) from barley applying the vertical dehuller DOO 1 we recommend dehulling 2 times.

For applying the vertical dehuller DOO 2, we recommend 2-3 times progressive dehulling of barley. For pea dehulling application, sieve with mesh 2.5 x 25mm (additional equipment-on request) is recommended.

Location of inlet and outlet can be positioned to suit the plant layout.

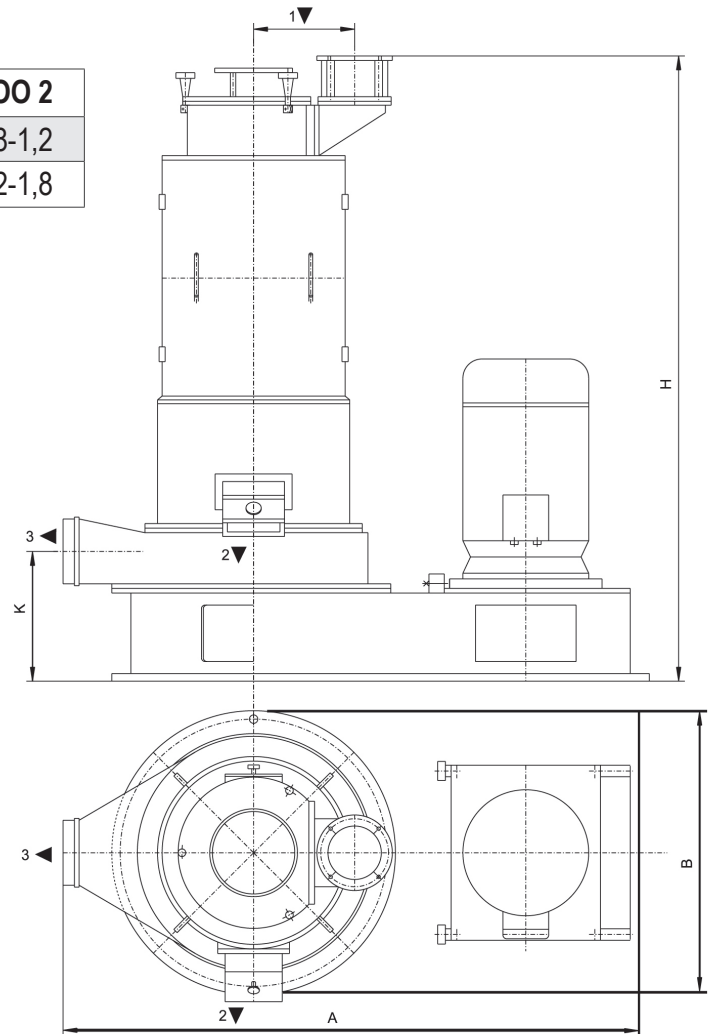

The dehuller is equipped with the following abrasive discs and cylindrical sieves:

BARLEY, 1ST DEHULLING	DOO 1	DOO 2
Conical disc. No. 12	1	1
Cylindrical disc. No. 12	1	3
Cylindrical disc. No. 16	2	3
Cylindrical sieve mesh 1.6 x 20	1	1
BARLEY, 2ND DEHULLING		
Conical disc. No. 16	1	1
Cylindrical disc. No. 16	1	3
Cylindrical disc. No. 20	2	3
Cylindrical sieve mesh 1,2 x 15	1	1